

Item Specification

CONTROL:	
Designer Name:	Charlie
Date:	26.06.25
ORDER DETAILS:	
Description:	Mc AW Autumnal Gnome INSTRUCTIONS
Barcode:	5052089384033
Supplier:	Ningbo Youngsun Arts & Crafts
Purchase Order:	TBC
Cutter from supplier:	Yes
ORDER PACKAGING:	
Packaging Type:	INSTRUCTIONS
Packaging Size:	x
Packaging Colours:	CMYK
Packaging Finish:	n/a
Cutter Guide:	DO NOT PRINT
Notes:	x

IMPORTANT INFORMATION:
In the event that the cutter guide needs to change from the version in this artwork, please **DO NOT** make **ANY** changes to our artwork without our prior acknowledgment as we will need to make all required changes in-house. We will not be able to approve any supplier-amended artwork and this may cause a delay to the shipping of these goods. In this instance, we reserve the right to cancel the order or reduce the order quantity.

重要提示:
如果The Works 提供的设计的die cut 需要更改, 请知会The Works. 请不要在我们同意之前, 对The Works 提供的设计, 做任何的修改。
The Works 不会批准, 任何供应商自行更改的设计。如果因更改设计, 而导致出货延迟, The Works保留取消订单, 或减少订单数量的权利。

make&create®

BEFORE BEGINNING THIS PROJECT, YOU'LL HAVE TO LEARN SOME BASIC CROCHET TECHNIQUES: MAGIC LOOP, DOUBLE CROCHET AND FASTENING OFF. TO START WITH, USE THE CROCHET HOOK TO CREATE A MAGIC LOOP.

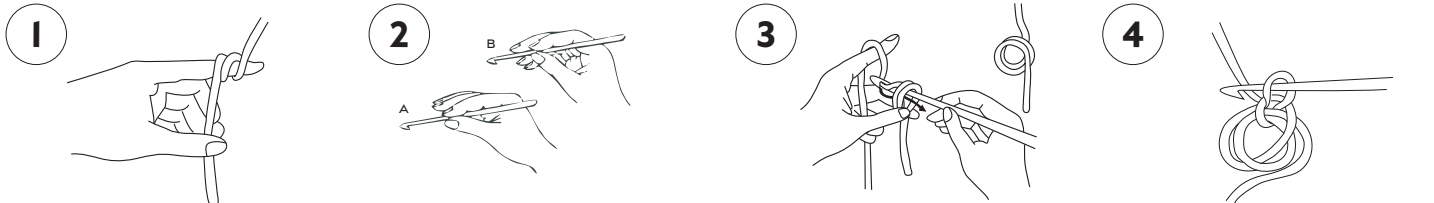

FOLLOWING THE ILLUSTRATION, WRAP THE YARN AROUND YOUR FINGER TWICE. LEAVE AT LEAST A 15cm TAIL, UNTIL YOU BECOME FAMILIAR WITH THIS METHOD.

USE YOUR THUMB AND INDEX FINGER TO HOLD THE HOOK. LEAVE 4cm FROM THE TIP OF THE HOOK TO YOUR FINGERS. REFER TO PICTURE 'A'. PLACE YOUR MIDDLE FINGER ON THE HOOK 1.5cm AWAY FROM THE TIP. KEEP THE OTHER TWO FINGERS CLOSE TO THE CROCHET HOOK. JUST AS PICTURE 'B' SHOWS.

FOLLOWING THE ILLUSTRATION, HOLD THE LOOP WITH 2 FINGERS THEN GRAB THE WORKING YARN WITH THE HOOK AND PULL IT BACK THROUGH THE LOOP.

YOU WILL HAVE ONE LOOP ON THE HOOK.

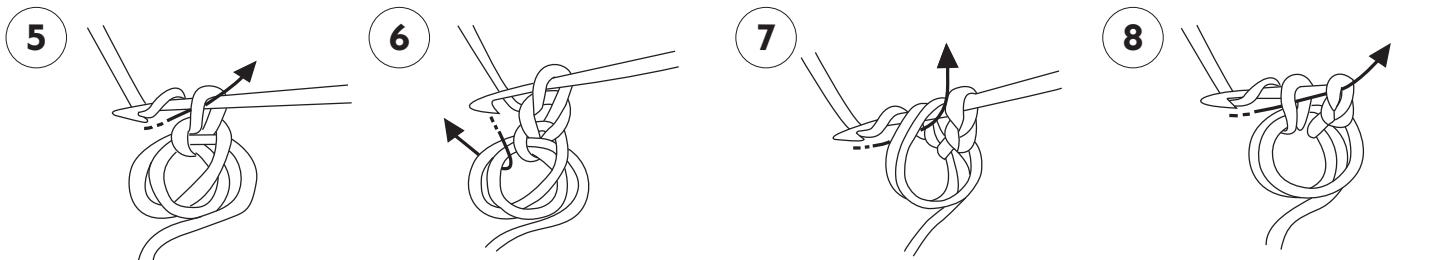

PULL THE WORKING YARN THROUGH THE LOOP WITH THE HOOK FOLLOWING THE DIRECTION OF THE ARROW.

INSERT THE HOOK PASSING THROUGH THE LOOP FOLLOWING THE DIRECTION OF THE ARROW. THIS CREATES A CHAIN STITCH.

PULL THE WORKING YARN THROUGH THE LOOP WITH YOUR HOOK FOLLOWING THE DIRECTION OF THE ARROW.

PULL THE WORKING YARN THROUGH BOTH LOOPS WITH YOUR HOOK FOLLOWING THE DIRECTION OF THE ARROW.

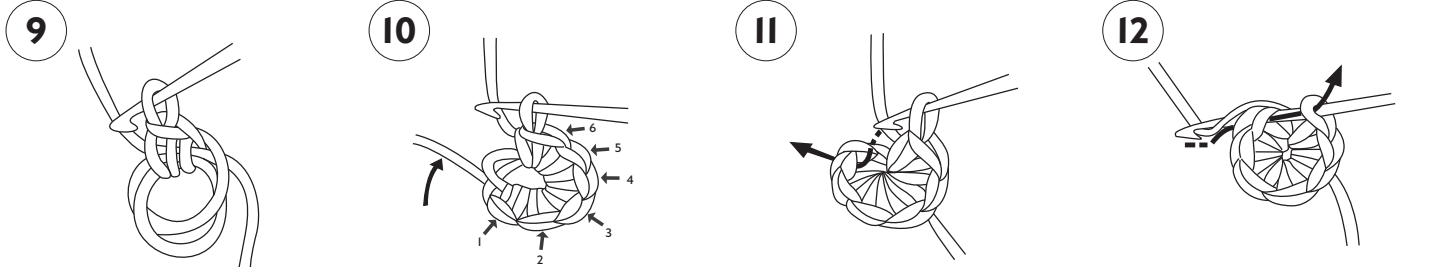

DOUBLE CROCHET MADE, PLEASE NOTE THESE TWO STEPS MAKE ONE STITCH.

KEEP DRAWING THE WORKING YARN THROUGH THE LOOP FROM THE DIRECTION OF THE ARROW. REPEAT STEPS 7 & 8 SIX MORE TIMES, COMPLETING 7DC.

INSERT THE HOOK THROUGH THE LOOP FOLLOWING THE DIRECTION OF THE ARROW.

PULL THE WORKING YARN THROUGH THE LOOP WITH YOUR HOOK FOLLOWING THE DIRECTION OF THE ARROW.

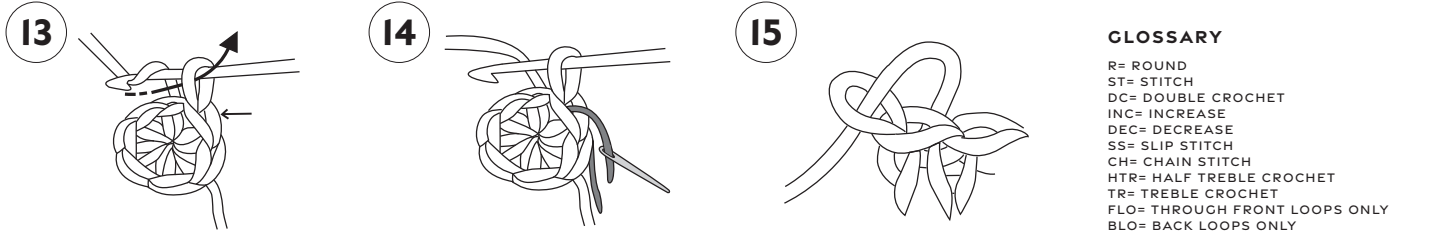

GLOSSARY

R= ROUND
ST= STITCH
DC= DOUBLE CROCHET
INC= INCREASE
DEC= DECREASE
SS= SLIP STITCH
CH= CHAIN STITCH
HTR= HALF TREBLE CROCHET
TR= TREBLE CROCHET
FLO= THROUGH FRONT LOOPS ONLY
BLO= BACK LOOPS ONLY
[G]= GREEN YARN
[R]= RED YARN
[Y]= YELLOW YARN
[W]= WHITE YARN
[BR]= BROWN YARN
[B]= BEIGE YARN
[O]= ORANGE YARN

HERE ARE SOME STITCHES AS FOLLOWS:

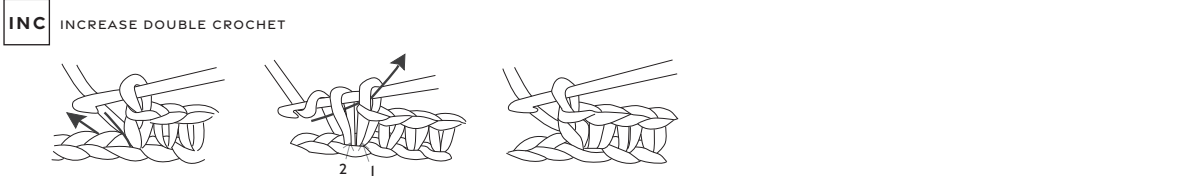
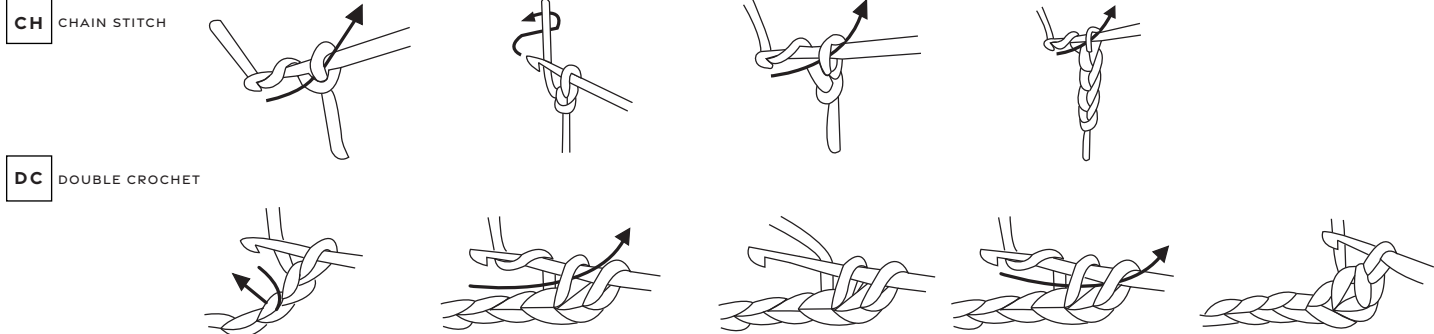

ADDITIONAL STITCH IN THE SAME SPACE MEANS YOU REPEAT A DOUBLE CROCHET TWICE FOR THE SAME STITCH SPACE LIKE THE ILLUSTRATION.

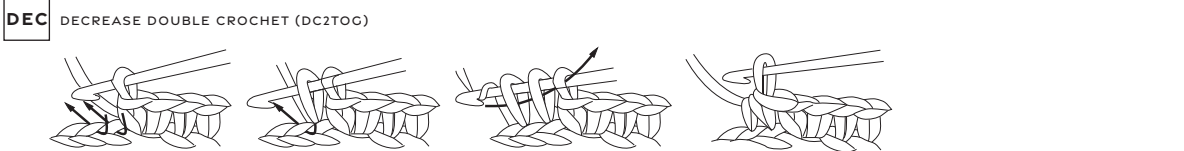

HTR HALF TREBLE CROCHET

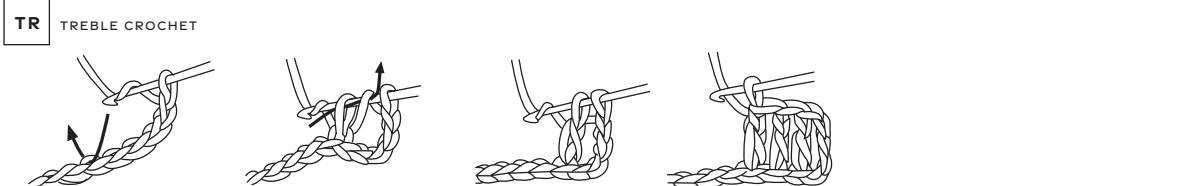

TO MAKE THE HAT

YOU WILL USE RED YARN [R] FOR THE HAT.

ROUND	PATTERN INSTRUCTION	STITCH	YARN
R1	DC 6 INTO A MAGIC RING	6	[R]
R2-R3	6DC	6	[R]
R4	2INC, 2DEC	6	[R]
R5	6DC	6	[R]
R6	2INC, 2DEC	6	[R]
R7	6INC	12	[R]
R8-R9	12DC	12	[R]
R10	6(DC, INC)	18	[R]
R11-R12	18DC	18	[R]
R13	6(DC, INC, DC)	24	[R]
R14-R15	24DC	24	[R]
R16	6(3DC, INC)	30	[R]
R17-R18	30DC	30	[R]
R19	6(2DC, INC, 2DC)	36	[R]
R20	36DC	36	[R]
R21	6(5DC, INC)	42	[R]
R22	6(3DC, INC, 3DC)	48	[R]
R23	6(7DC, INC)	54	[R]
R24	6(4DC, INC, 4DC)	60	[R]

CUT THE YARN AND LEAVE A LONG TAIL TO ATTACH THE BODY.

TO MAKE THE ARMS

YOU WILL USE BEIGE YARN [B] AND GREEN YARN [G] FOR THE HANDS.

ROUND	PATTERN INSTRUCTION	STITCH	YARN
R1	DC 6 INTO A MAGIC RING	6	[B]
R2	6INC	12	[B]
R3-R4	12DC	12	[B]
BEGIN STUFFING THE HAND.			
R5-R12	12DC	12	[G]

FINISH STUFFING THE ARMS, THEN CUT THE YARN LEAVING A LONG TAIL TO ATTACH THE ARMS TO THE BODY.

TO MAKE THE BODY

YOU WILL USE ORANGE YARN [O] FOR THE BODY.

ROUND	PATTERN INSTRUCTION	STITCH	YARN
R1	DC 6 INTO A MAGIC RING	6	[O]
R2	6INC	12	[O]
R3	6(DC, INC)	18	[O]
R4	6(DC, INC, DC)	24	[O]
R5	6(3DC, INC)	30	[O]
R6	6(2DC, INC, 2DC)	36	[O]
R7	6(5DC, INC)	42	[O]
R8	6(3DC, INC, 3DC)	48	[O]
R9-R14	48DC	48	[O]
R15	6(3DC, DEC, 3DC)	42	[O]
R16-R17	42DC	42	[O]
R18	6(5DC, DEC)	36	[O]
R19-R20	36DC	36	[O]
BEGIN STUFFING THE BODY.			
R21	6(2DC, DEC, 2DC)	30	[O]

FINISH STUFFING THE BODY, THEN CUT THE YARN AND FASTEN OFF.

TO MAKE THE NOSE

YOU WILL USE BEIGE YARN [B] FOR THE NOSE.

ROUND	PATTERN INSTRUCTION	STITCH	YARN
R1	DC 6 INTO A MAGIC RING	6	[B]
R2	6INC	12	[B]
R3-R4	12DC	12	[B]
BEGIN STUFFING THE NOSE.			
R5	6DEC	6	[B]

FINISH STUFFING THE NOSE, THEN CUT THE YARN LEAVING A LONG TAIL TO ATTACH THE NOSE TO THE BODY.

TO MAKE THE LEGS

YOU WILL USE GREEN YARN [G] FOR THE LEGS.

ROUND	PATTERN INSTRUCTION	STITCH	YARN
R1	DC 6 INTO A MAGIC RING	6	[G]
R2	6INC	12	[G]
R3-R4	12DC	12	[G]
BEGIN STUFFING THE LEG.			
R5	6DEC	6	[G]

FINISH STUFFING THE LEGS, THEN CUT THE YARN LEAVING A LONG TAIL TO ATTACH THE LEGS TO THE BODY.

TO MAKE THE SUNFLOWER

YOU WILL USE BROWN YARN [BR] AND YELLOW YARN [Y] FOR THE SUNFLOWER.

ROUND	PATTERN INSTRUCTION	STITCH	YARN
R1	DC 4 INTO A MAGIC RING	4	[BR]
R2	4INC	8	[BR]
R3	8DC	8	[BR]
R4	BLO 8[CH1, HTR, CH1, CH1, CROCHET THE 2 CHAINS TOGETHER (USE SLIP STITCH), CH1, SS]	24	[Y]
R5	FLO OF R3, 8[CH2, TR, CH, CH1, CROCHET THE 2 CHAINS TOGETHER (USE SLIP STITCH), CH2, SS]	24	[Y]
R6	8(CH3, SS) CROCHET BETWEEN R2 AND R3	8	[B]

FASTEN OFF. WEAWE IN ENDS.

TO MAKE THE 10 SPOTS

YOU WILL USE WHITE YARN [W] FOR THE SPOTS.

ROUND	PATTERN INSTRUCTION	STITCH	YARN
R1	DC 6 INTO A MAGIC RING. SS IN FIRST DC. FASTEN OFF	6	[W]

CUT THE YARN AND LEAVE A LONG TAIL TO ATTACH THE HAT.

ATTACHING THE GONK

JOIN ALL PARTS TOGETHER:



HAT ON THE BODY

STUFF THE HAT, THEN PLACE THE HAT IN THE POSITION YOU WANT IT TO SIT ON THE GNOME'S BODY. USING THE TAIL YOU SAVED AFTER COMPLETING THE BODY, ATTACH IT TO THE HAT BY SEWING THE TAIL IN AND OUT ON THE BODY. USE YOUR NEEDLE TO PULL THE YARN THROUGH. ONCE YOU HAVE SEWN ALL THE WAY AROUND AND THE HAT IS ATTACHED, PULL YOUR YARN INSIDE THE HEAD AND LEAVE IT IN THERE.

ARMS ON THE BODY

PLACE ONE OF THE ARMS IN THE POSITION YOU WANT IT TO SIT ON THE GNOME'S BODY. USING THE TAIL YOU SAVED AFTER COMPLETING THE ARM, ATTACH IT TO THE BODY BY SEWING THE TAIL IN AND OUT ON THE BODY. USE YOUR NEEDLE TO PULL THE YARN THROUGH. ONCE YOU HAVE SEWN ALL THE WAY AROUND AND THE ARM IS ATTACHED, PULL YOUR YARN INSIDE THE BODY AND LEAVE IT IN THERE. REPEAT THIS FOR THE SECOND ARM.

LEGS AND NOSE ON THE BODY

PLACE THE FIRST LEG IN THE POSITION YOU WANT IT TO SIT ON THE GNOME'S BODY. USING THE TAIL YOU SAVED AFTER COMPLETING THE LEG, ATTACH IT TO THE BODY BY SEWING THE TAIL IN AND OUT ON TO THE BODY. USE YOUR NEEDLE TO PULL THE YARN THROUGH. ONCE YOU HAVE SEWN ALL THE WAY AROUND AND THE LEG IS ATTACHED, PULL YOUR YARN INSIDE THE BODY AND LEAVE IT IN THERE. REPEAT THIS FOR THE SECOND LEG AND THE NOSE.

SPOTS AND FLOWER ON THE HAT

THREAD THE PLASTIC NEEDLE WITH WHITE YARN. AND INSERT THE NEEDLE FROM THE BACK OF THE HAT, LEAVING A TAIL. PULL THE NEEDLE OUT AT THE DESIRED POSITION OF THE SPOT ON THE GNOME'S HAT. USE THE BACKSTITCH METHOD TO SEW THE SPOTS ONTO THE HAT. ONCE ALL THE SPOTS ARE SEWN, PULL THE THREAD THROUGH THE ENTRY POINT, TIE A KNOT WITH BOTH ENDS, AND CUT OFF THE YARN. USE THE PLASTIC NEEDLE TO TUCK THE YARN ENDS INTO THE HAT. SEW THE FLOWER ONTO THE HAT USING THE INVISIBLE STITCH METHOD, PLACING IT AS SHOWN IN THE PICTURE ON THE RIGHT.

MOUSTACHE AND POM POM ON THE SPOTTY GONK

WRAP THE WHITE YARN AROUND YOUR FINGERS THREE TIMES, ABOUT 5cm IN LENGTH. TAKE A PIECE OF YARN AND PASS IT THROUGH THE LOOP, TYING A KNOT. REPEAT THE SAME STEPS TO MAKE 9 MORE. THREAD THE PLASTIC NEEDLE, INSERT THE NEEDLE FROM ONE SIDE OF THE BODY, LEAVING A TAIL. PULL THE NEEDLE OUT AROUND THE NOSE AND USE THE BACKSTITCH METHOD TO SEW THE MOUSTACHE AROUND THE NOSE. ONCE THE MOUSTACHE IS SEWN ON, PULL THE THREAD THROUGH THE ENTRY POINT, TIE A KNOT WITH BOTH ENDS, AND CUT OFF THE YARN. USE THE PLASTIC NEEDLE TO TUCK THE YARN ENDS INTO THE BODY. ATTACH THE POM POM TO THE TOP OF THE HAT USING A GLUE GUN. THE GNOME IS NOW COMPLETE.

TO MAKE THE MOUSTACHE

YOU WILL USE WHITE YARN [W] x10

